







-  Fahrbahn, Asphalt
-  Gehweg
-  Radweg
-  Radfurt
-  Pflasterinsel
-  Grünfläche
-  Planungsgebiet



Projekt: 2010-005-14 Bahnstadt Heidelberg Plan: 2028

 Müller Ingenieurplan GmbH
 76137 Karlsruhe Ettlinger Str. 27
 Tel. 0721 / 91380-0 Fax 0721 / 91380-30

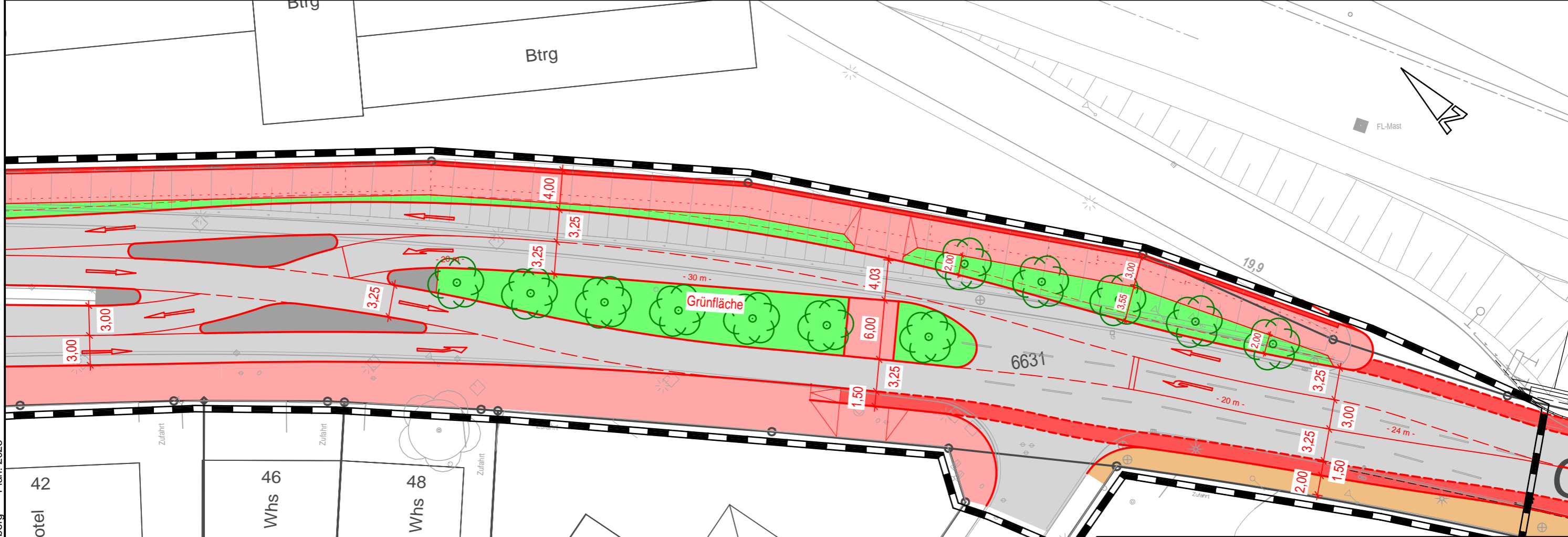
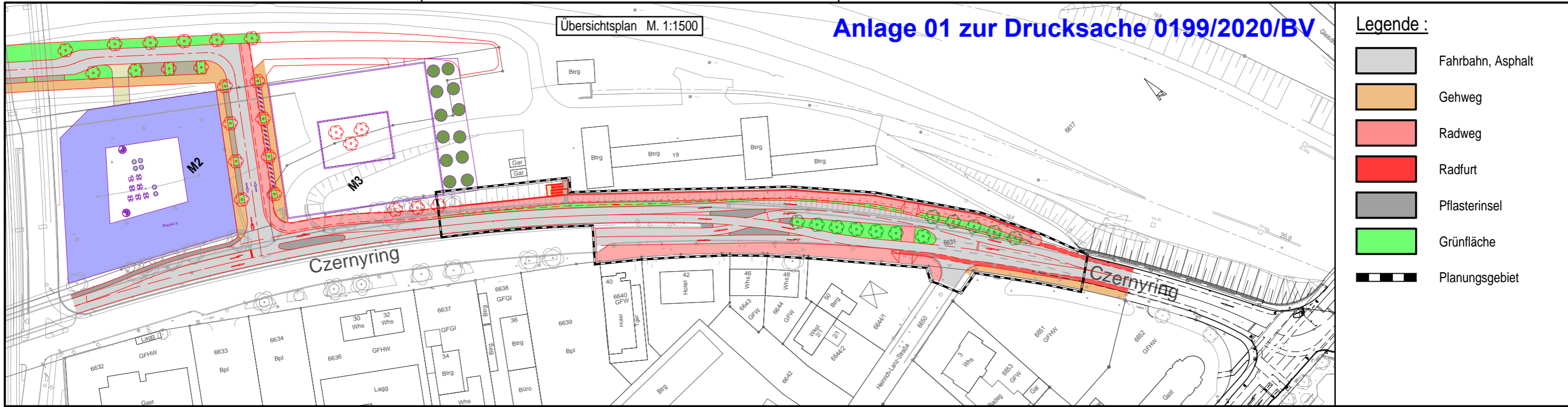
 **Heidelberg**
 Stadt Heidelberg
 Amt für Verkehrsmanagement

Umbau Czernyring (Schere Ost)
 zwischen Heibelstraße und Montpellierbrücke

Maßnahmenübersicht Datum: 22.05.2020